

**SL 1 for Serato Scratch Live**

The Rane SL 1 is the ultimate solution for bridging the analog world of vinyl and the digital world of computer audio files. Using regular turntables or CD players, you can scratch and mix files from your Mac or Windows computer's CD or hard drive, add in a live mic input for scratching, and even bypass to standard vinyl if you wish. Take your entire collection wherever you go and leave your precious vinyl and CDs at home!

The SL 1 interface connects one or two standard vinyl or CD turntables to your computer and the mixer of your choice. This extremely rugged, portable, high quality, bus-powered USB interface features two switchable phono or line inputs, a microphone input, two line outputs, and pass thru outputs for the phono/line and mic.

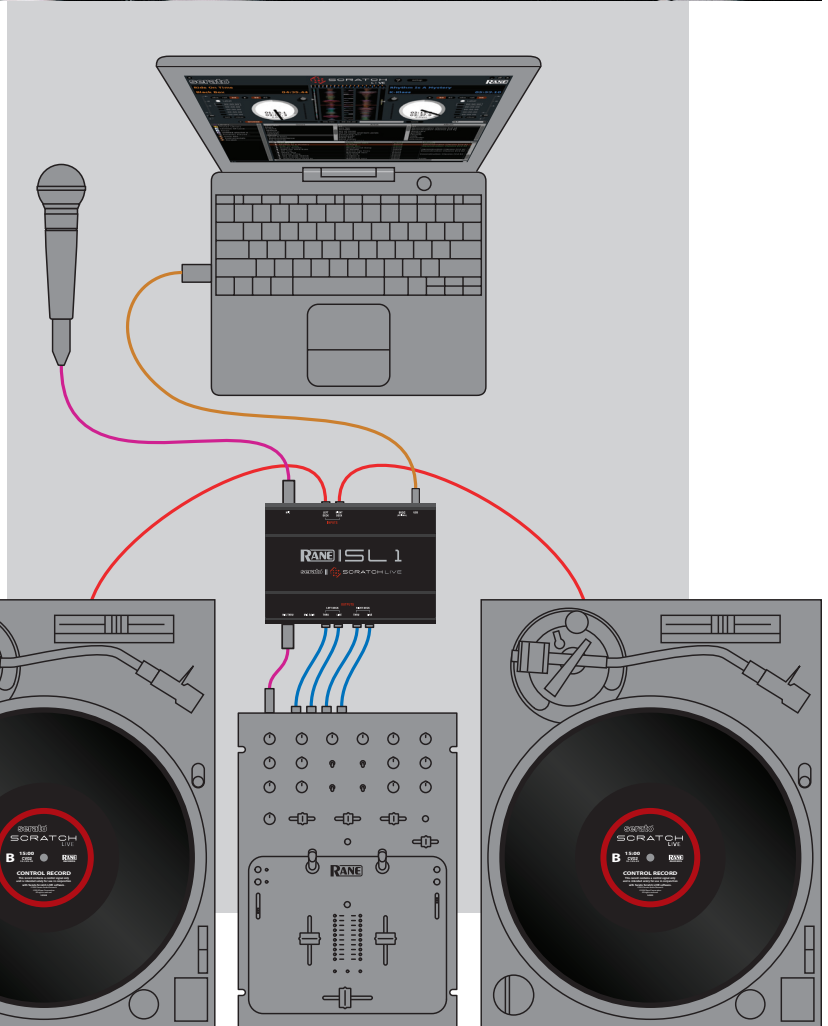

The included 12" vinyl records each have Serato's exclusive and unique control signal which allows Scratch Live to track the motion of the record, simulating the same movement with digital audio. Due to Serato's proprietary control scheme, the result is a feel and sound indistinguishable from playing vinyl. As a producer and DJ, the track you finished today can be played on a real turntable tonight. You'll never have to cut a dubplate again!

**SOFTWARE**

Scratch Live supports all these file formats: Fixed and Variable Bit Rate MP3, AIFF, AAC, WAV, OGG Vorbis, CD Audio and direct from the mic input.

Import files easily by dragging from Explorer (Windows) or the Finder (Mac) into the Scratch Live library. Easily import your playlists and iTunes library.

You can play and scratch tracks direct from CD and CD-ROM.

Includes extensive keyboard shortcuts for efficient function access.

Built-in help and tips in multiple languages are accessible anytime.

Low power warning when running off a laptop battery.

No preprocessing of MP3 files is required except to use the auto-BPM and auto-gain functions.

Auto-BPM detects tempo information for tracks without it, saving it with each file. A tap tempo button allows you to enter your own.

Includes Coreaudio and ASIO drivers.



The scope display is invaluable for troubleshooting turntable problems.

Customize your interaction with the many options in the setup screen.



Scratch Live has different operating modes that can be assigned to each Virtual Deck.

**Absolute Mode –**

exact reproduction of record movement, needle drop through tracks – just like normal vinyl. The beginning of the track is mapped to the start of the record.

**Relative Mode –**

skip-free scratching, jump to cue points, and pitch bend buttons combined with turntable control. This mode observes the relative forward and backward movement of the record, but does not regard the position within the record.

**Internal Mode –**

mix with just your laptop using features modeled on DJ CD players. ◀◀◀ Rewind, ◀◀ Bend down, ◀ Play / pause reverse, ▶ Play / pause forward, ▶▶ Bend up, ▶▶▶ Fast forward.

**Auto mode –**

play a sequence of tracks automatically.

Record from your Mic and immediately scratch as if it was on vinyl.

Record direct from vinyl or CD and save as 16-bit 44.1 kHz stereo file.

The crate and subcrate system helps organize your library and sets.

Hot swap external drives with fast automatic library merging and re-tention of crates.

MIDI control can interface USB controllers with Scratch Live.

Tempo display assists with rapid tempo matching of tracks. When the two tracks are matched to the same tempo, the peaks will line up.

Beat display emphasizes the transients in tracks – these are matched up when the two tracks are beat matched.



The Virtual Deck shows everything about the speed and position of a track. As the vinyl rotates, so does the line on the label. The circular progress bar around the edge is a visual representation of the position within the song. The time and remaining time are displayed in minutes and seconds. The turntable speed as a percentage of pitch shift is on the left, and the pitched BPM is on the right.

Variable zoom waveforms centered around current position – display horizontal or vertical. Waveforms are colored by frequency – distinguish instruments visually.

Auto-gain lets you set a target gain on any or all songs in your library. You can also manually adjust individual gain, remembered in each song file.

Full track overview: Quickly find where the beat drops, find break-downs and choruses, and jump to any part of the song.

With Key Lock on, the key or pitch of the song stays locked at what it would be if the track was playing at normal speed, regardless of the platter speed of the turntable or CD player. Key Lock has scratch detection, so it automatically turns off when scratching for a natural scratching sound.

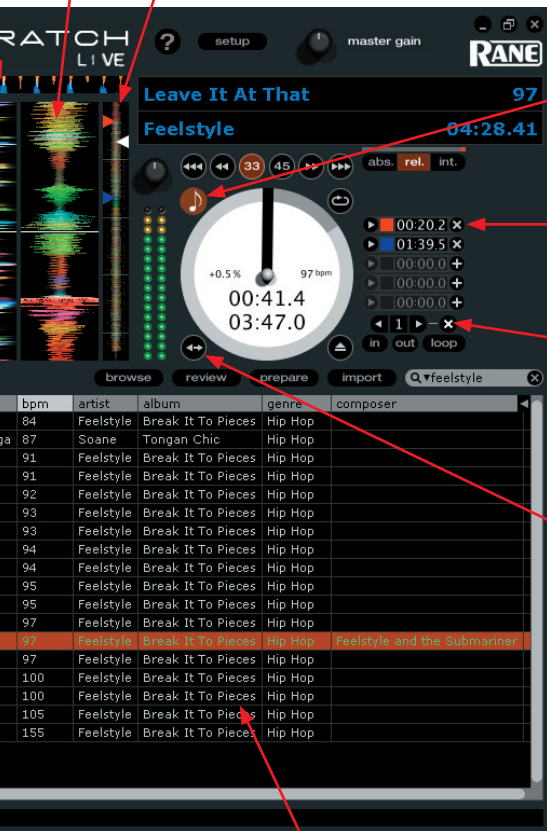

Visual markers can be set for up to 5 cue points per song and triggered from the keyboard.

Save up to 9 loops per track – these loops are saved in the file, and will be present when you reload.

Censor expletives on the fly with an instant quick-reverse and catch-up with no loss of timing or pitch.

When a track is loaded, the track name, artist and length are displayed in the track title bar, and the Virtual Deck shows a solid black line. The track starts playing as soon as it detects the signal from the control vinyl (or CD).

Browse your music collection by album, artist, BPM, or genre, with optional album art display.

Intuitive search function can be applied to any field to find things quickly.

Edit ID3 tags with full Unicode support.

Turntable lock feature only allows loading on a stopped deck to prevent accidental track changes.

Instant doubles – load the same track on both decks at the same point for instant flange effect and back-to-backs.

### CONTROL VINYL & CDs

Side A: 10 minutes plus Vinyl Scroll track. Side B: 15 minutes.

Continuous control signal on vinyl allows smooth accurate scratching. Scratch Live has the lowest latency vinyl emulation system on the market. It has advanced vinyl groove and stylus modeling algorithm for a sound indistinguishable from the real thing.

Innovative positioning system allows fast and accurate needle dropping. The record has thin marks every minute, and a thicker mark every 5 minutes (played at 33 RPM). These marks assist you when using needle dropping to move through the track.

The Vinyl Scroll track allows you use your turntable or CD to scroll through your crate and pick the next song without touching your laptop.

Two 15-minute control CDs are included.



**HARDWARE INTERFACE (SL 1)**

USB 1.1 (full speed) interface with ultra-low latency drivers. Bus-powered for fast, simple set up.

Phono level inputs for direct connection of 2 turntables to your computer — no phono preamp required.

Line level inputs — no extra hardware required for CD decks and line-level turntables.

Input-thrus allow you to switch instantly back to playing regular vinyl.

Microphone input with adjustable gain, and a Microphone thru output.

The analog circuitry is fully isolated from the noisy USB Bus.

Optional external power pack for permanent installations, or for switching computers during a live show.

The thick cast aluminum chassis will survive most road collisions.

**MINIMUM SYSTEM REQUIREMENTS**

- A DJ mixer with at least 2 channels.
- At least one turntable or CD player.
- Computer with USB 1 port (USB 1.1).
- Screen res. 1024 x 768 or higher.
- Hard drive space for storing music.

**Mac**

- 1 GHz G4 with 1 GB RAM
- OSX 10.3.9 or higher
- Intel Mac compatible

**Windows**

- 1.5 GHz PC with 1 GB RAM
- Windows XP with Service Pack 2 or higher, or Vista. We recommend Windows XP over Vista for performance reasons. By using XP, you can have a lower latency (for a better vinyl feel) and better performance in general.

**Note:** This is the minimum requirement to run Scratch Live. We recommend a higher spec computer, and if you have a large library, you will benefit from having more RAM.

**Note:** No sound card is necessary.

**SL 1 SPECIFICATIONS**

(all specs typical)

USB Power	300mA, 5.0 Volts
Optional External Power Pack	300mA, 9.0 Volts
CODEC	16-bit / 44.1 kHz sample rate
Line Output:	Unbalanced RCA
.....THD+N	-88 dB (1 kHz, 0 dBu, 20 kHz BW)
.....Maximum Output	+5 dBu, +3 dBV
.....Dynamic Range	94 dB A-weighted
Input to Thru	Unbalanced RCA
.....Gain	Unity
.....Maximum Input / Output	2 Vrms
.....Dynamic Range	110 dB A-weighted
Phono Input	Unbalanced RCA
.....Maximum Input	35 mVrms
Line Input	Unbalanced RCA
.....Maximum Input	2 Vrms
Mic Input to ADC	Unbalanced ¼" Tip-Sleeve
.....Maximum / Minimum Gain	49 dB / 9 dB
.....Maximum Input	150 mVrms
Mic Thru	Unbalanced ¼" Tip-Sleeve
.....Gain	+6 dB
.....Maximum Output	300 mVrms
.....Noise	3.5 uVrms A-weighted

**IN THE BOX**

- SL 1 interface
- 2 (two) control CDs
- 2 (two) control records
- 1 USB cable
- 4 stereo RCA cables
- Quick start guide
- Scratch Live software install disc
- SL 1 manual

**SCRATCHLIVE.NET**

New features are always being added and improved, and the latest version is a free download. Scratchlive.net is also the best place for technical support and performance tips from thousands of other DJs.

**MJW**  
MAC | WIN  
**USB**



© 2008 Rane Corporation. All rights reserved. Scratch Live and the Scratch Live logo are the trademarks of Serato Audio Research. Trademarked in the U.S. and other countries. Licensed exclusively to Rane Corporation.