



JS-5 JamStation

Kick Out the Jams



With the BOSS JS-5 JamStation, guitar and bass players can instantly jam along to high-quality accompaniments, create new accompaniments, and even record up to 32 minutes of their playing without any knowledge of MIDI sequencing or recording. This innovative tabletop backing machine features hundreds of songs with 4-part arrangements that can be easily structured to fit user-defined chord progressions—giving musicians a simple, yet effective way to practice, jam, build complete musical arrangements and write songs.*

**Optional 32MB SmartMedia card required to expand JS-5's recording time to 32 minutes.*

- Highly intuitive backing accompaniment machine and song composer for guitarists
- Professional-quality sound engine with separate reverb, chorus, and multi-effects
- 200 Preset songs with 4-part backing tracks
- 100 User songs and 26 user-definable chord progressions
- Separate audio track and mic/line/guitar input for recording live input sources
- Recording time expandable up to 32 minutes with SmartMedia™ card
- Built-in Timestretch feature automatically syncs audio recordings to internal patterns
- Locator function loops selected passages for practicing or jamming
- Assignable footswitch can be used for start/stop or loop control

** Product pictured is a prototype model. Actual product appearance may be subject to change.*

The Hottest Rhythm Section Around

The JS-5 is your ticket to playing with the hottest rhythm section in town. Through its unique Backing Generator, this compact tabletop machine creates full four-part accompaniments—perfect for guitar players who perform alone, or anyone just wanting to jam. And there's no need to be an expert in MIDI sequencing; the JS-5 has 200 Preset songs ready to go—just tell it what chords to follow and the tempo you'd like, then start playing along. Individual parts can be muted for using the JS-5 as a preset drum machine with bass sounds, and up to 26 User chord progressions and 100 User songs may be stored in internal memory. Better still is its separate audio track, which can be used for recording an input source to be played back with one of the JS-5's internal songs.

Simplified Audio Recording

Recording to the JS-5's dedicated audio track is no different than recording to tape—just hit the Record button and start playing. This built-in audio track is great for recording up to 32 minutes* of vocals, guitar, or even CD's, and until now, this feature was completely unheard of in a preset backing machine. A selectable input source ensures the JS-5 is properly matched to the type of instrument connected to its input—be it a microphone, line-level source or guitar. Even more amazing is the JS-5's ability to automatically sync audio recordings to any of its onboard songs through the use of a Timestretch function. This time-saving feature makes it possible to create full accompaniments, complete with digital audio, in a matter of minutes.

*Optional 32MB SmartMedia card required to expand JS-5's recording time to 32 minutes.

Helpful EZ Compose Feature

Creating arrangements in the JS-5 is simple, thanks to a new EZ Compose feature. By pressing the EZ button, users can select styles and chords through an interactive system that eliminates hidden menus—just cursor to the item to be modified and use the Value dial. With EZ Compose, guitarists can create and jam along to great-sounding backing accompaniments quicker than most bands can do a live sound check.

Sample Setup

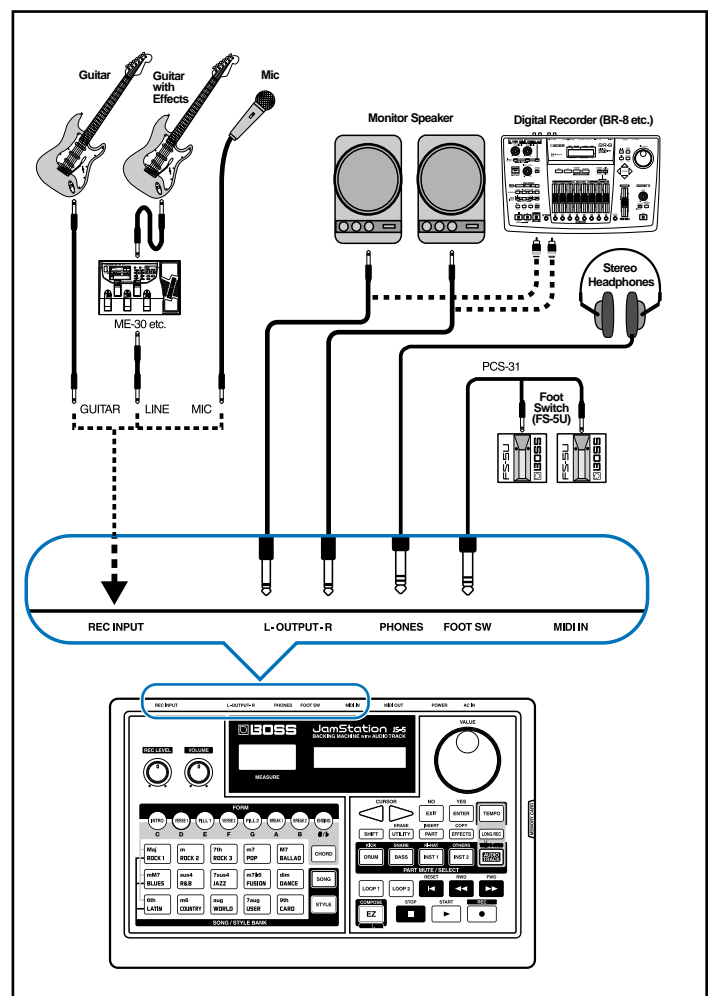

Specifications

Number of polyphony
64

Number of styles
Preset: 200 x 8 forms (Intro, Original, Fill1, Variation, Fill2, Break 1, Break 2, Ending) User: 20 x 8 forms

Number of Songs
Preset: 200 User: 100

Resolution
96

Data input method
Realtime and step

Display
16-character x 2 -Line, 7-segment LCD

Connectors
Recording Input, Output (L, R), Headphones, Footswitch, MIDI (IN, OUT), DC IN

Dimensions
269(W) x 176(D) x 63(H) mm / 10-9/16" x 6-15/16" x 2-1/2"

Weight
1.1 kg / 2 lbs. 7 oz. (excluding AC Adaptor)

*The specifications are subject to change.



JS-5 Rear Panel