

# The best turntablist mixer in the world just got better!

## TTM 56 TO TTM 56S IMPROVEMENTS

- *Internal* universal power supply works anywhere in the world (100-240 VAC).
- *All four inputs* are now Phono/Line switchable, now letting you plug in 4 turntables or 4 CD players, or any combination.
- Both ¼" and 3.5 mm headphone jacks are on the front.
- Transform switches are now Kill switches.
- Operation is simplified by putting all the controls you need on top, and increasing the width by one inch.

## GENERAL FEATURES

- Mic input with EQ and dedicated effects loop.
- Crossfader and Channel Faders all have Contour and Reverse controls.
- Stereo Aux Input for session mix or keyboard.
- Stereo Aux Output for session mix, booth or recording.
- Post-fader FlexFX™ allows external reverb and echo decay effects to respond to fader action.
- High, Mid & Low *Accelerated Slope*™ tone controls go from +6 dB to off — full bass and treble cut.

## NON-CONTACT CROSSFADER & CHANNEL FADERS

Rane's patented magnetic fader is the fastest, most accurate, and longest lasting on the planet. The design uses non-contact magnetic position sensor technology previously reserved for aerospace and industrial applications. Unlike optical non-contact faders, the magnetic fader is impervious to smoke, moisture, temperature and aging. The electrical performance is totally unaffected by use. No noise, no bleed — ever!



## EXAMPLE SYSTEM

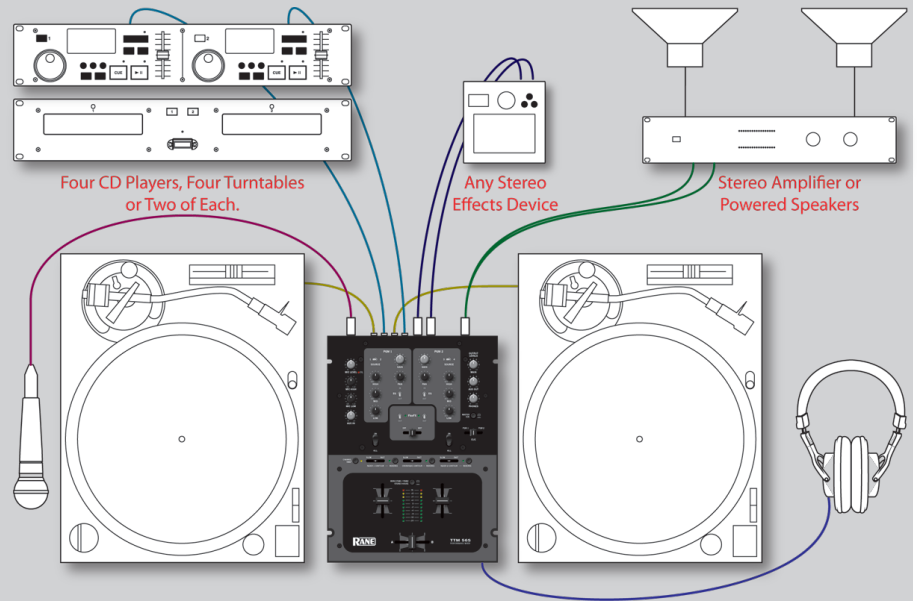

# TTM 56S

## PERFORMANCE MIXER



### REAR VIEW



### SIDE VIEW

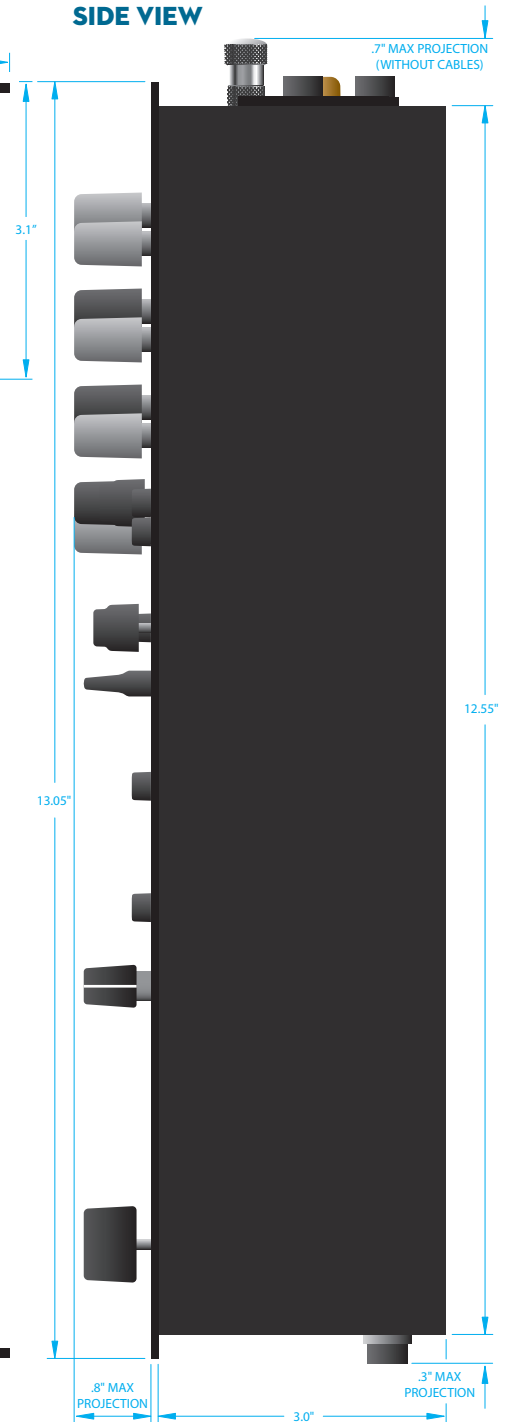

### ACCESSORIES

#### CASE 2 Road Case

This durable Pelican™ case has added space beneath the mixer for headphones, cables, phono cartridges and other small items. The case measures 7.5" x 15.75" x 19.75" (19 x 40 x 50 cm) and weighs 9 pounds (4 kg).



#### MFC 1 Mixer Foam Cover

This dense foam cover is an inexpensive protection for mixer knobs and sliders. The cover installs easily with two velcro straps. Put your TTM 56S in a suitcase or backpack without fear of damaging the controls on the way to your show. The cover measures a thin 1" x 10.5" x 13.5" (2.6 x 26.7 x 34.3 cm). The cover weight is only 5.2 ounces (148 grams). Shipping weight is 1 pound (400 grams).



### FRONT VIEW



Views are 50% actual size