



Ready
Acoustics

Hear - sound - Better

CHAMELEON SERIES C16 Standard Room Package

(Studio, Theater, Office, Restaurant, and more)

The C16 Standard Room package offers professional acoustic treatment performance at a great price. Whether you are an audio professional or you're just seeking the very best sounding room with the best looks for your money, the C16 delivers both. Sixteen (broadband) Chameleon bass traps deliver performance that cannot be accomplished using simple foam. With so many choices of fabric and frame color, you'll be asking yourself why you hadn't "tuned your room" sooner. Chameleon bass traps help to eliminate stubborn standing waves, peaks and nulls, "boominess" and echo in critical listening environments. The C16 helps you enjoy crisp articulation in your audio sound that is lost in non-treated rooms. The C16 will deliver more punch, more clarity and more "truth" in your audio mixes, and will enhance your overall Home Theater experience. The C16 also works great in smaller Offices and Restaurants that require improved speech intelligibility, by reducing harsh echoes and noise.

"Ready Acoustics made me feel like I just bought a new set of ears." - **Jeff Juliano**, Mix Engineer for **James Blunt, John Mayer, Josh Kelly, Lifehouse, Rachel Yamagata, Dave Matthews Band** and many more

Features

- Easy to Use
- Class A Fire Rated
- Clear, Accurate Sound
- Unprecedented, even Bass response
- 52 Beautiful Color combinations
- Professional Grade construction
- Modular, "go anywhere" design
- REAL Lab certified effectiveness
- Unbeatable Performance
- Superior Value
- Versatile mounting options

Description

- Steel Framed Construction
- Weight: 14.5 lbs (each panel)
- Dimensions: roughly 48" x 24" x 4"
- Class A Fire Rating

Included in this package

- 16, Broadband Chameleon Acoustics Panels/ Bass traps
- Installation Hooks
- Decorative Hanging Chain
- Free room acoustics advice and "live" installation and placement support

Sample configuration: (note: this is just one configuration example, and your individual installation may differ based on your specific needs)

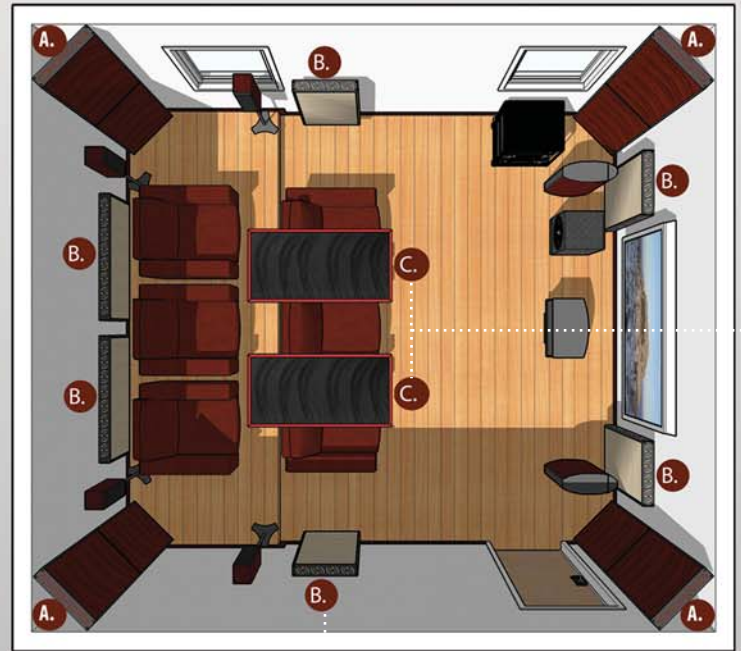
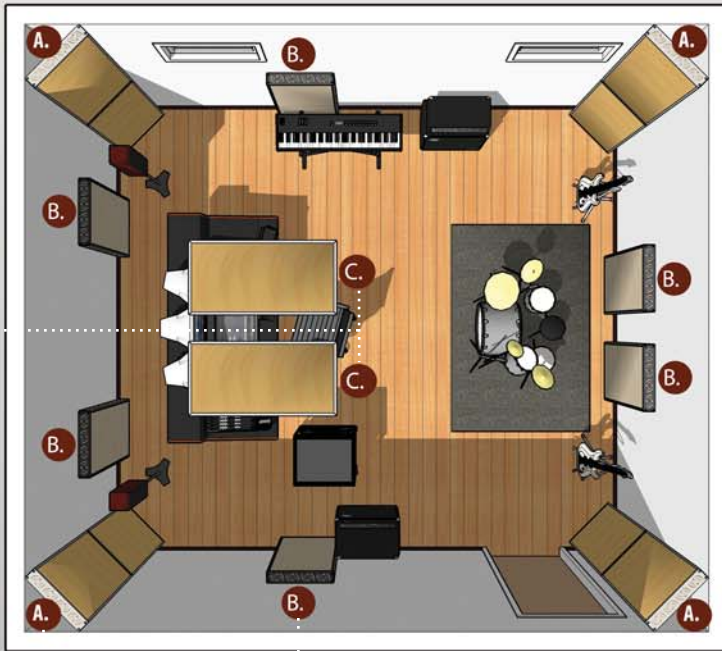

A. Chameleon Panels (broadband bass traps) across vertical corners for efficient bass trapping. Chameleon Acoustic Panels help reduce room resonances, and bass buildup in corners. Bass trapping provides a first line of defense against audio “smear” and facilitates accurate perception of lower bass at your listening position. Proper placement of Chameleon Bass Traps enhances the “thump” and pump of bass in a tight, controllable way that makes music and audio far more pleasurable and precise in this critical frequency range.



B. Chameleon Panels (broadband bass traps) to control early reflections. Controlling Early Reflections is the key to a sharply defined stereo image. Using Chameleon Acoustic panels will add depth and clarity to your stereo imaging and help to put specific sounds in their proper place across a MUCH wider and more focused sonic landscape.

C. Chameleon Panels (broadband bass traps) on the ceiling for additional Early Reflection and bass absorption. Installing Chameleon Acoustical Panels in these areas helps create an even tighter bass response and further enhances stereo imaging.

D. Chameleon Panels (broadband bass traps) for additional Bass Absorption. Installation of bass traps across corners is not limited to vertical corners only. In just about any room, a corner is a corner is a corner and bass traps across horizontal corners can provide as much bass absorption as installation in vertical corners.

4 Rules for Broadband Acoustical Treatment for critical Listening Environments

1. Layout your system and listening position symmetrically – Acoustically render the left half of the room as an exact mirror image of the right half. For optimal sound, place special emphasis on the symmetry in the front of your room, where your system components and listening position are located. Non-symmetries in the front portion of your room, pose more problems than behind your listening position.
2. Use broadband absorbers [minimum 4” / 100 mm thick] so that your treatments work on all frequencies [lows, mids, and highs] in a linear fashion [evenly / smoothly].
3. Smooth out uneven bass response (very low frequency resonances) that exists in all small rooms by installing 4” thick corner mounted treatments. As a standard guide for optimal treatment, add a pair of vertically stacked 4” thick corner panels in each of 4 room corners [total = 8 corner mounted bass traps]. If vertical corners are not available, then use any available horizontal corners [ceiling/wall or floor/wall corners]. If you cannot install 8 corner panels of 4” thickness, then use thicker panels in the corners you do have available.
4. Treat Early Reflection Points with additional broadband absorbers. As a standard guide for optimal treatment, hang a pair of panels on the front wall, 1 panel each on the side and rear walls, and 3 panels on the ceiling – each located so they mask the first reflection points [total = 8 reflection point panels].