

WARRANTY INFORMATION

Ultimate Support Systems offers a Limited Lifetime Warranty on Apex Keyboard Stand Series. For Full Details, Exclusions and Limitations as well as information on Obtaining Warranty Service, please see full warranty details available online at www.ultimatesupport.com.

To purchase the Ultimate Protection Plus Premium Service and Support Plan, please visit www.ultimatesupport.com or call customer support at **800-525-5628** for more information.

WARRANTY REGISTRATION

Visit www.ultimatesupport.com for a quick and convenient process for registering your new Ultimate Support product. Warranty Registration and Proof of Purchase are required for warranty fulfilment. Full Limited Lifetime Warranty and Ultimate Protection Plus Premium Service and Support Plan details are available online.

ULTIMATE SUPPORT™

THE STRENGTH OF INNOVATION

Product Manual
for Ultimate Support

APEX KEYBOARD STAND SERIES

AX-90B
ITEM #16761
BLACK PEARL

AX-90OR
ITEM #16763
ORANGE

AX-90P
ITEM #16765
PEWTER

AX-90W
ITEM #16766
WHITE PEARL

AX-90BL
ITEM #16768
BLUE

AX-90R
ITEM #16769
RED



BOOM NOT INCLUDED

Revision 1, 03.18.09 . Product Manual Item #APEX-M

CAUTION: To preserve color finish on stand use tote bag and instruction provided for setup and TIER down in manual.

APEX STAND & TOTE BAG

APEX STAND STORES IN TOTE BAG FOR PROTECTION

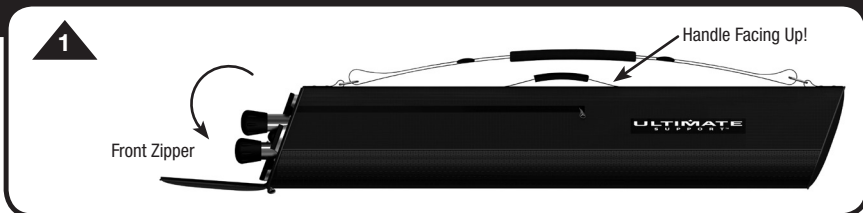

STEP 1

Lay your Apex Tote Bag on the ground with handle facing up. Unzip end of bag exposing all four legs. **DO NOT REMOVE TOTE BAG YET!**

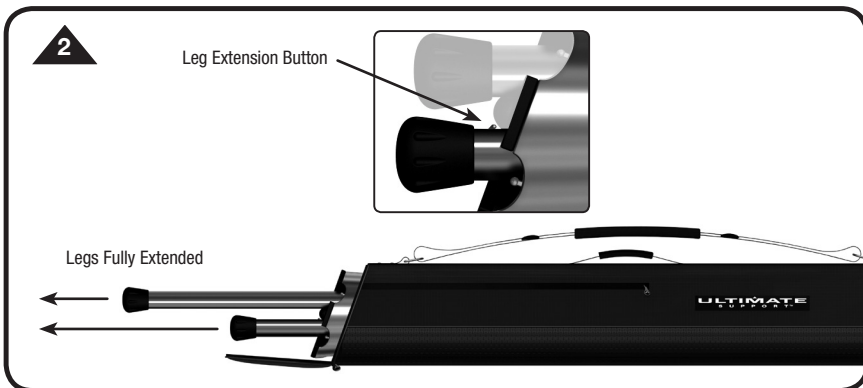

STEP 2

Locate Leg Extension Buttons on inside of Apex legs. Push Button in and extend legs. Make sure legs are fully extended. **DO NOT REMOVE TOTE BAG YET!**

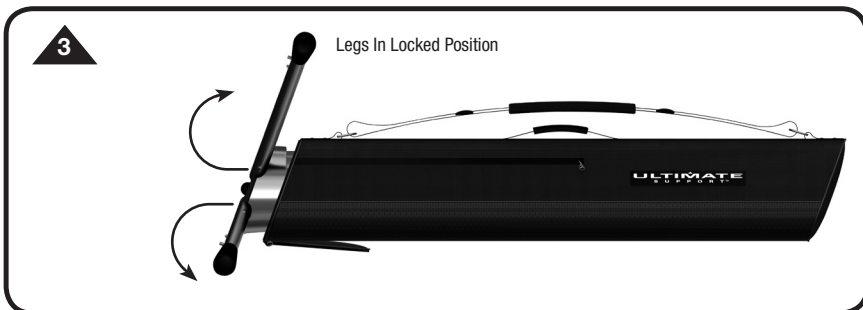

STEP 3

Fold legs out until they lock in position. **DO NOT REMOVE TOTE BAG YET!**

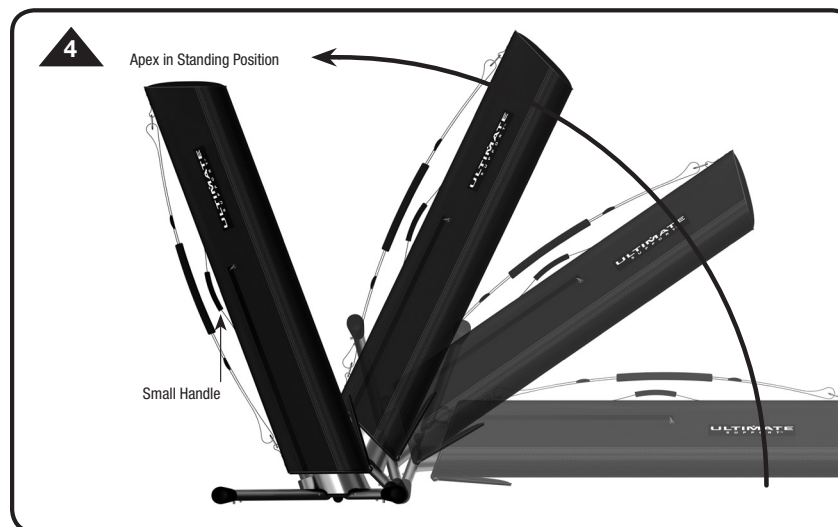

STEP 4

Pull Apex Stand up onto its legs using the small handle on tote bag. Do not remove the bag until the stand is in an upright position.

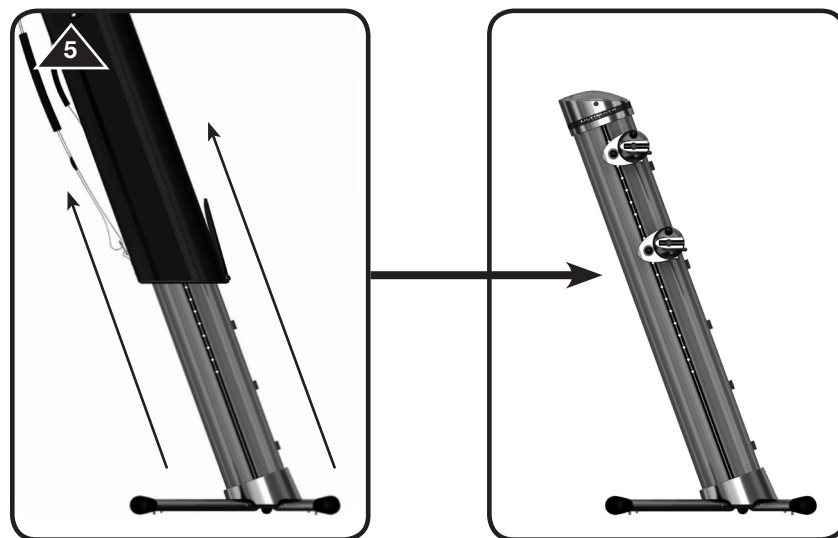

STEP 5

Pull tote bag off stand.

APEX ARMS & ADJUSTMENTS

ADJUST HEIGHT, LENGTH, AND ANGLE

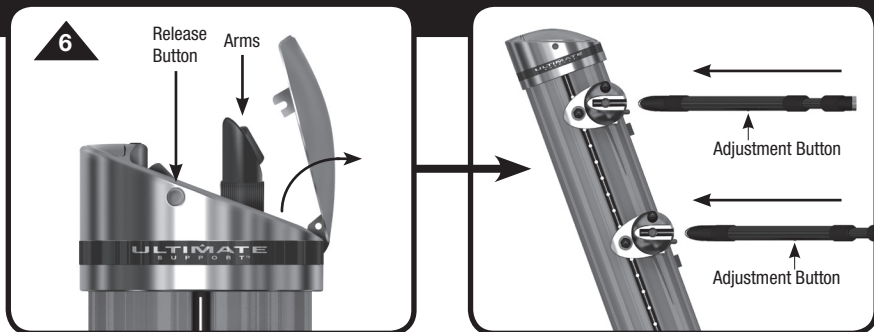

STEP 6

Press red release button to pop cap and pull out arms. Snap arms into place, adjustment buttons face down, and logos on arms read right side up. Make sure arms are locked into position by pulling back on arms.

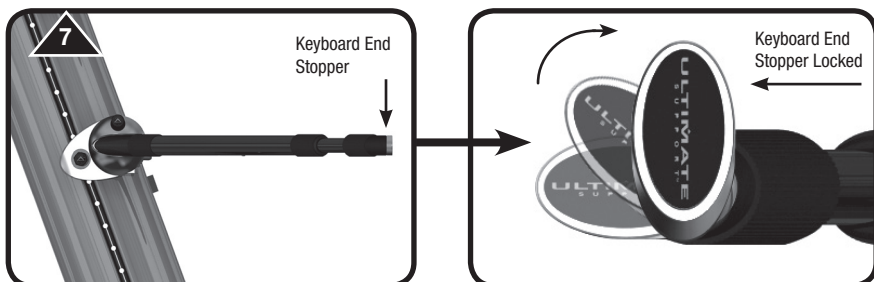

STEP 7

Twist Keyboard End Stops to hold keyboard in place. Keyboard End Stops must be folded back for storage.

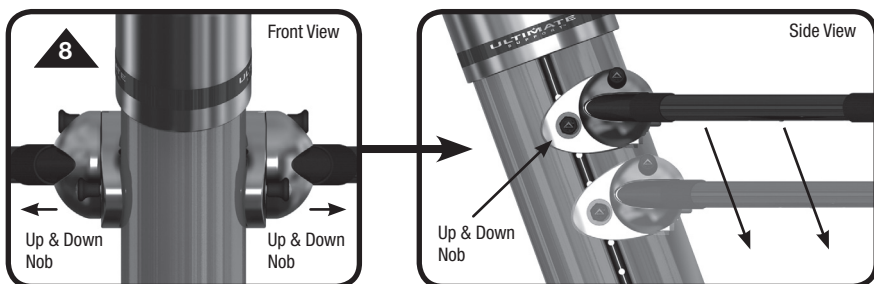

STEP 8

To adjust the tier height pull on both nobs on front side of tiers at the same time. Adjust up or down to desire height. At desired height release nobs and press down to ensure locked position.

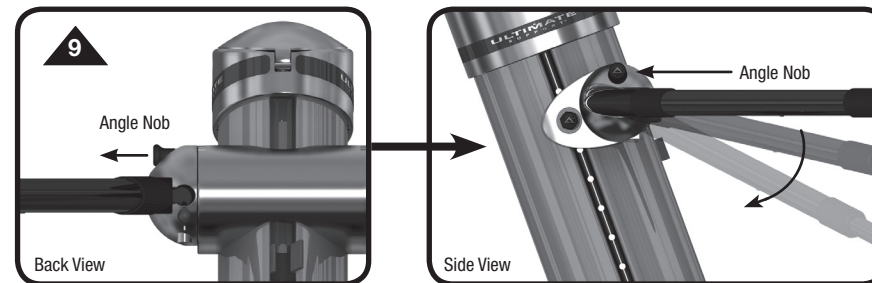

STEP 9

To adjust arm angle pull the nob on the desired side. Snap arm into place aligning red lines. Repeat for remaining arms.

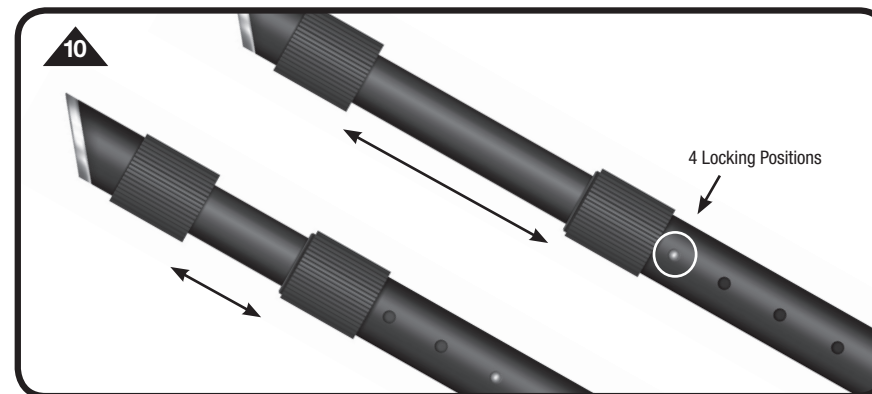

STEP 10

To adjust arm length push in buttons on bottom of arms and adjust out or in.

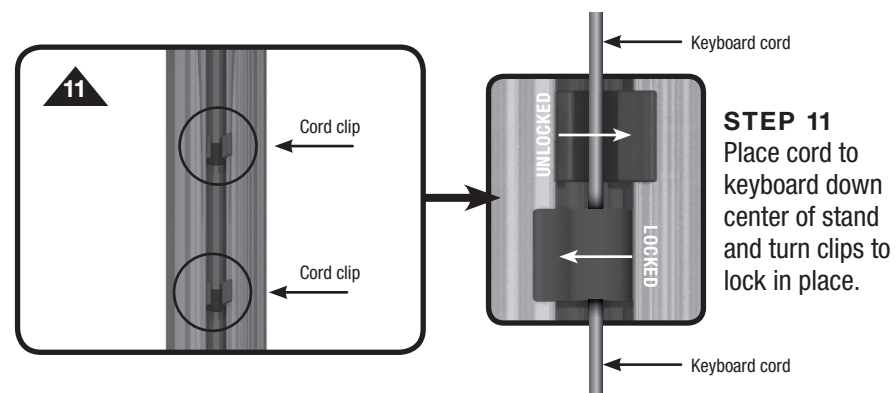

STEP 11
Place cord to keyboard down center of stand and turn clips to lock in place.

APEX TIER DOWN

FOLDS UP FOR CONVENIENT STORAGE



STEP 1
Twist Keyboard End Stops to closed position. Keyboard End Stops must be folded back for storage.



STEP 2
Press red button below arm and pull to detach arm. Press red top button to pop cap and place arms inside. Arm end with logo goes in first. Arms should fit easily in holes. If top does not close check arms to make sure they are properly put into holes.



ARMS NEED TO BE IN THE PROPER ORIENTATION.

STEP 3
Slide bag over stand. Handle should be facing front and on same side as longer legs.



STEP 4
Standing behind of stand pull tote bag towards you while walking backward and lay tote bag on ground. Handle should be on top.

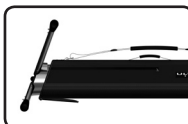

STEP 5
Release legs so that they are ready to be pushed in.

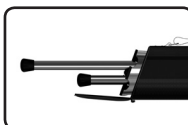

STEP 6
Push legs in until they snap inside stand. Zip up bag for next use.

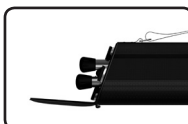

APEX ACCESSORIES

TOTE BAG & TELESCOPING BOOM

-Included with all Apex Stands



AX-90BAG TOTE BAG

Bag designed to aid in set-up and TIER-down, protecting the stand's finish. Simply store the tiers inside the top of the stand and slip the bag over the top. Laying the bag down with the stand inside, store the legs in the bottom and zip up the bag end. Bag has top end handle and carrying strap.

- AX-90BAG #17263
- Heavy-duty, padded and zippered Tote Bag. Holds one AX-90 Series
- 1-year warranty

Column Keyboard Stand, plus one AX-90MIC boom.



-Not included
-Available Separate

AX-90MIC BOOM

Telescoping "Ulti-boom" utilizes height adjustment channel inside of the New Apex body. Super clean looks combined with perfect functionality. Quickly detaches and stores in protective Apex Bag pocket.

- AX-90MIC #17222
- Telescoping boom length 18.9" - 33.9" (480 mm - 860 mm)
- 1-year warranty